

Toyo University International Residence

International House

Application Guide for  
Study Abroad students

Spring 2026



## 1. Basic Information

- Residence name Toyo University International House (I-House)
- Address 3-2-4 Sendagi, Bunkyo-ku, Tokyo, 113-0022
- Building 7 stories built in August, 2008
- Capacity 117 beds

### Management of this residence

Management of the International House is provided by National Students Information Center Co. LTD. (NASIC) . Toyo University together with NASIC offer safe and comfortable residence life to its residents. Residents will be contacted by NASIC regarding payment of the housing fee and application for moving-in and -out.

National Students Information Center Co. LTD. (NASIC)

### Dormitory Manager and Resident Assistant

Dormitory managers live on the first floor and work in the manager's office. The office is open from 8 AM through 7 PM on weekdays and Saturdays.

Resident Assistants (RAs) are student staff who live in the I-House and provide various support for residents. They have passed rigorous screening process and have been properly trained. When residents have any concerns or issues, they should talk to RAs first.

## 2. Application eligibility

Students who meet all of the following requirements are eligible to live in the International House:

- 1) Current Toyo students (both undergraduate and graduate) or international exchange students (**first-year undergraduate students are not eligible**);
  - 2) Those who can observe the residence rules;
  - 3) Those who can live with other residents in the same building and participate in events and programs provided in the residence
  - 4) Those who can obtain parents' agreement (for students under 20 years old only)
- ※Non-degree-seeking students and students in correspondence course are not eligible to apply
  - ※Students who take a leave of absence are not eligible to live in the I-House

during the period of leave.

3. Period of stay

- Students studying at Toyo for one semester: From March 30, 2026 through August 10
- Students studying at Toyo for two semesters: From March 30, 2026 through February 10, 2027

4. Facility

① Unit types

The following illustrations are examples. Actual unit layout may be different from the illustrations below. **Please note that even if you prefer a single-occupancy bedroom, you will be assigned to a single-occupancy bedroom in the double or triple unit, where you will share a living space, bathroom, and kitchen with other resident(s).**

Priority is given to students with medical or other considerations. Currently, there is no vacancy for study abroad students without special considerations. Please contact International Affairs Office in advance.

- **Double unit** : 2 single-occupancy bedrooms, shared living space, kitchen, and bathroom

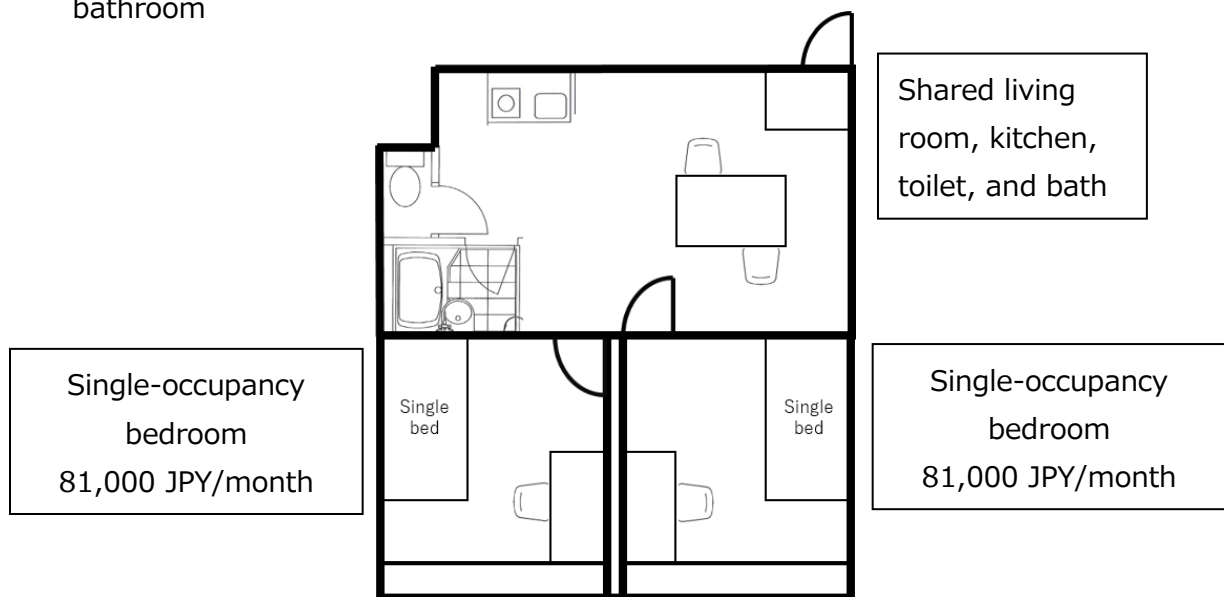

Two Single-occupancy bedrooms



Shared living room



Shared living room



Shared kitchen

- **Triple unit** : 1 single-occupancy bedroom, 1 double-occupancy bedroom, shared living space, kitchen, and bathroom

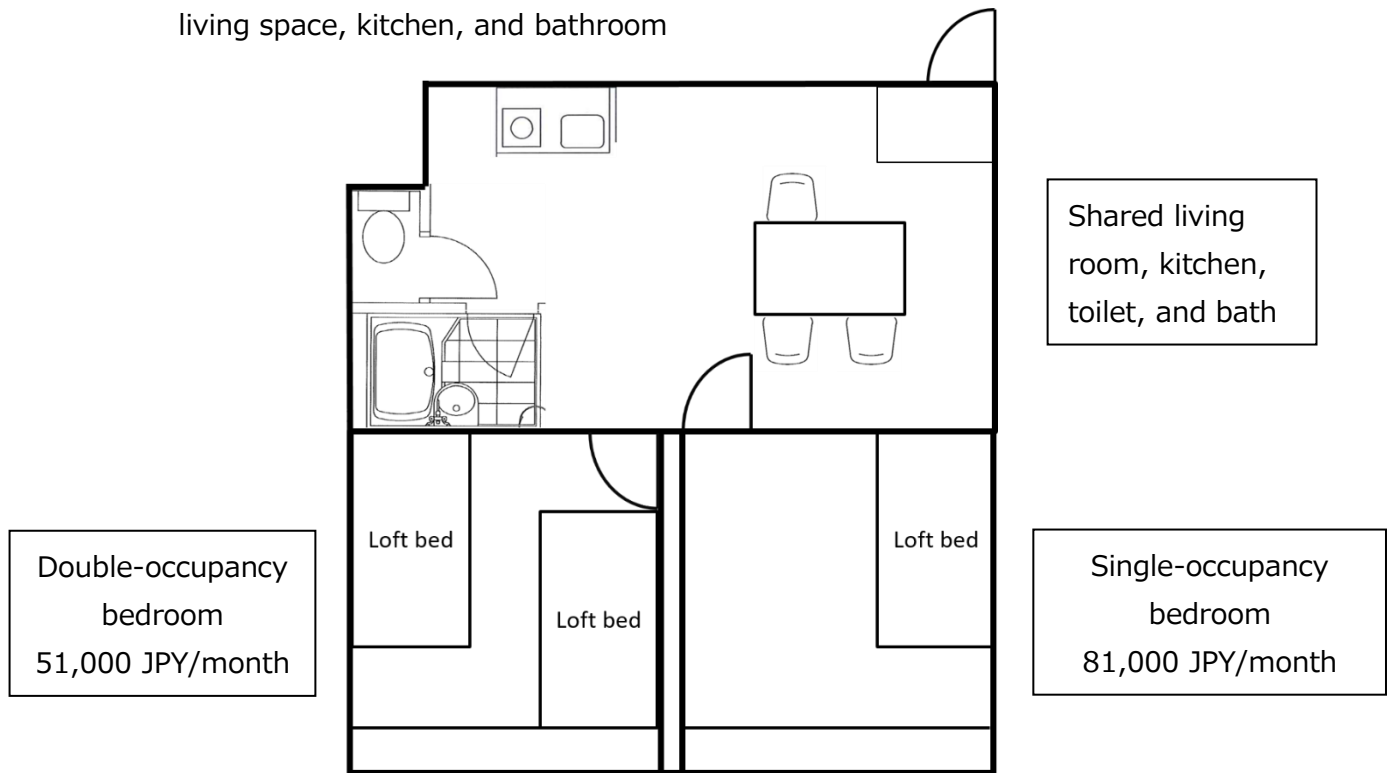

Single-occupancy bedroom(left)  
and Double-occupancy bedroom(right)



Double-occupancy bedroom  
(A loft type bed)



Single-occupancy  
bedroom



Shared living room

② Equipment list ● = Available in unit ○ = Available in shared space × = Not available

Bed	●
Desk and chair	●
Closet	●
Curtain	●
Air-conditioner	●
Lights	●
Desk light	●
Hanging pole	×
Internet (Wi-Fi)	●
Bedding items	※

Renting bedding items is required. Its fee is not included in the monthly housing fee.

#### Electrical items

● = available in individual room ○ = available in common areas

△ = can be borrowed × = not available

Refrigerator	●
Washing machine & dryer	●
Rice cooker	×
Microwave	●
Iron	×
Vacuum cleaner	△ (free)
Bicycle (with electric support)	×
Kettle	×
Hair dryer	×
TV	×
Printer	×
Copy machine	×

#### Other items

● = available in individual room ○ = available in common areas

△ = can be borrowed × = not available

Dishes & cutlery	×
Cooking items	×
Toilet paper	×
Tissues	×
Bath mat	×
Hanger	×

※Even for the items marked as “not available,” there are some items that the previous residents donated to the I-House. Many units actually have cooking items. We encourage you to move in with minimum necessary items and check what is in your unit before purchasing items.

### Important notes on unit types

- Although we will do our best to assign residents to their preferred room/unit type, please understand that because of limited space and high demand, this will not always be possible. Rooms/units are assigned at the discretion of Toyo University and cannot be changed except under extraordinary circumstances.
- Because the number of single units is limited, **it will not be possible to place you in the single unit unless there is a special consideration.**
- If you are assigned to a single-occupancy bedroom, it will be in a double or triple unit. The same rate applies to all three unit types.
- Please contact the Housing Team if you have any concerns that may affect unit assignment.
- The monthly housing fee varies based on whether you stay in a single-occupancy or double-occupancy bedroom, but not on the unit type.

### 5. Meals

No meal is provided in the International House. If you prefer a residence with meal plans, please consider applying for the AI-House HUB-4.

## 6. Fees

Semester		Unit Type	
		Single-occupancy bedroom	Double-occupancy bedroom
One semester students	2026/3-2026/8	363,500 JPY	233,500 JPY
Full-year students	2026/3-2026/8	417,500 JPY	267,500 JPY
	2026/9-2027/2	447,000 JPY	287,000 JPY

Rental fee of bedding items : 2,500 JPY per month

※The monthly housing fee includes utility charges and internet fees.

### <How to pay>

- One semester students will be requested to pay the dormitory fee in one installment by **February 28, 2026**.
- Full-year students will be requested to pay the dormitory fee in two installment  
 First payment (by **February 28, 2026**) : 417,500 JPY (Single-occupancy bedroom)  
 267,500 JPY (Double-occupancy bedroom)  
 Second payment (by **July 31, 2026**) : 447,000 JPY (Single-occupancy bedroom)  
 287,000 JPY (Double-occupancy bedroom)
- You will receive an online invoice through the service called Flywire. You can pay by credit card or international bank transfer (bank transfer may not be available in some countries).
- Please be careful of your credit card's limit.
- The paid housing fee is basically non-refundable.

## 7. Application procedure

- 1) Submit a response to the Housing Preference Survey
- 2) Lottery may be conducted if more students applied than the number of available spots.
- 3) You will be contacted by the Housing Team.
- 4) Complete the payment (see the above section for details)
- 5) Submit your flight and arrival schedule in our form shared later
- 6) Travel to Japan and check in

The official moving-in period is March 30-April 2. You should arrive at and check into the dormitory during this period. Starting from April 3, we plan to offer various orientations.



#### 8. Inquiries

Please contact us through the application portal.

#### 9. Sexual Minority and students with health or other concerns

Toyo University respect diversity and gender equality and provide maximum support for sexual minority students. In the residence as well, we will try to make as much arrangement as possible. However, there is also limitations on what we can offer due to the residence facility and capacity.

When you apply for the residence, please declare the sex that is on your passport. Room/Unit assignments will be done based on the sex that is on your passport.

If there is anything that you would like us to consider or we should know in deciding your residence, please communicate with us in advance.